

Enhance Your Company Values Interactive & Intelligent

I-Reception™

Application

- Company digital signage
- Visitor & staff welcome board
- Product & service advertising display
- Internal communication & News letter

Easy management S/W

- Scheduled Autoplay
- Internet based content upload
- Multi-media content : Text / Photo / Video / Web link
- Customer-oriented content navigation by built-in touch

Luxury design harmonized customer's interior

- Lobby / Elevator hall / Company entrance
- Hotel lobby / Information map / Residence entrance and etc.



Value propositions

Customer impression

- Welcome Board
- Company information
- Staff profile
- Customer-oriented info.

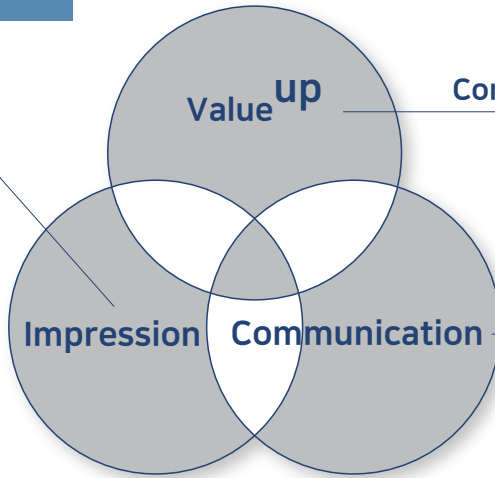

Corporate value enhancement

- Company brand awareness
- Product promotion

Internal comm. channel

- Newsletter portrayal
- Main events announcer



< Lobby >



< Elevator hall >



< Company entrance >

How to upload content

[With CMS* & Cloud server]

- ▶ User-friendly CMS

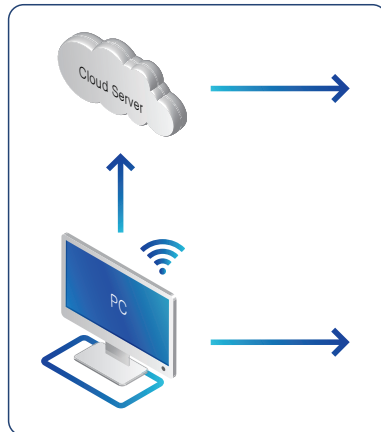

* CMS : Content management S/W

[Player]

- ▶ Memory stick content play, cell phone mirroring

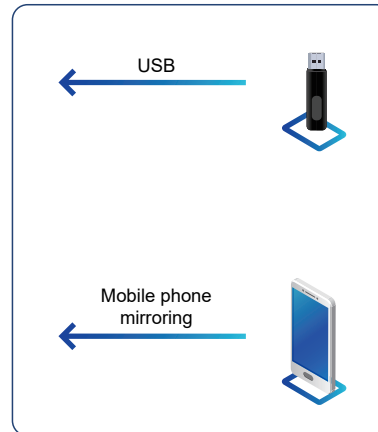

Features

- Ultra slim interactive digital signage
- Flat rear board design adjacent to the wall
- Luxury colors harmonized customer's interior
- FHD/UHD resolution
- Wide viewing angle
- 24/7 operation
- Android or Windows
- WiFi / Bluetooth / Mobile phone mirroring
- With Touch (Max.10 multi points)
- Built-in speaker
- Customizing service
 - Customer's logo (option)
 - Wall mount / Floor stand* (option)
 - Non-mirror glass / Mirror glass* (option)
 - Remote control by CMS software* (option)



▶ Flat rear board design

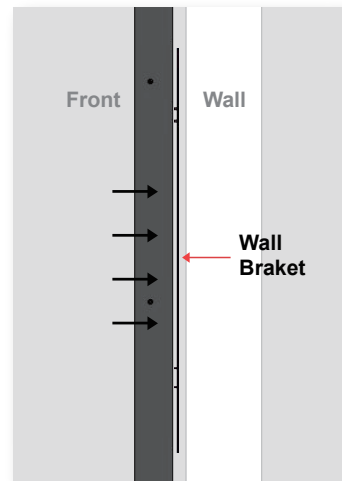
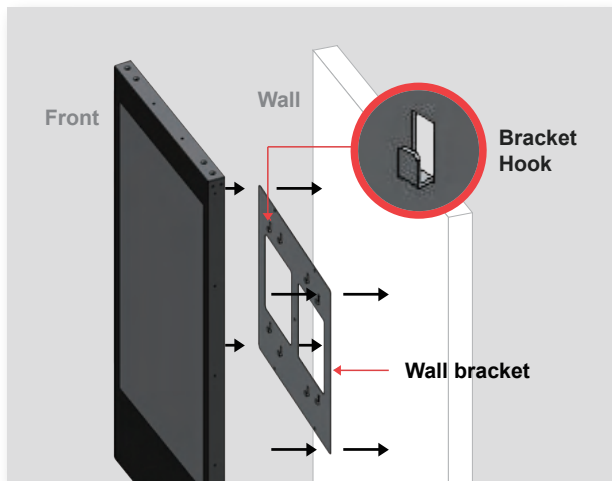

SPECIFICATION

Model		NIR430	NIR430U
Display	Panel Size (inch)	43	
	Resolution	1920 x 1080	3840 x 2160
	Brightness (Typ.)	400 cd/m ²	700 cd/m ²
	Contrast Ratio (Typ.)	1000 : 1	
	Viewing Angle (H)/(V)	178°/178° (Typ.)	178°/178° (Min.)
Touch Screen	Touch Input Method	Finger, Pen(Capacitive)	
	Multi Touch Point	10	
	Available Object size	Φ8mm(Finger), Φ3mm(Active Pen)	
	Response Time (Min.)	16ms	
	Glass Thickness	3mm	
	Transmittance (Min.)	Clear - 85% Mirror (option) - 30%	
System	OS	Android 9.0	
	CPU	RK3328	
	Memory	DDR4 2GB	
	Storage	eMMC 16GB	
	Graphics	Mali 450	
	LAN	10/100 Mbps	
	Wifi	802.11 a/b/g/n	
	I/O Interface	USB2.0/ RJ45	
Power	Input	AC100V ~ 240V(50/ 60Hz)	
	Consumption (Typ.)	75W	94W
Mechanical	Size (H x V x D, mm)	597 x 1294 x 50	
	Weight (kg)	33.6	

* Product specifications are subject to change without notice.